

98



5th Wheel Interiors, Floor Plans and Specifications



36RL Triple Slide Park Avenue with Bayside Blue Decor





*A new frontier of
fifth wheel quality and luxury*



Combining top quality features and high value, today's Park Avenue is the ideal choice for comfort, convenience and versatility. Consider its vacuum-bonded laminated sidewalls, fully reinforced with tubular aluminum framing for great body strength and *less* weight. The fiberglass exterior is laminated onto a styrofoam material for strength and high insulation value, able to withstand the harshest treatment and weathering and still maintain its great looks for years to come.



28RK Fifth Avenue in Galileo Green decor

Fifth Avenue takes the comforts and conveniences of the Park Avenue to a new standard. Fiberglass front and rear caps, an electric front jack and the addition of day/night shades are but a few of the 'extras' that set the Fifth Avenue apart from the competition. When you're ready to pack up and go, be sure to take everything you need— you'll find extraordinary storage throughout. Even the exterior compartments are carpeted, lighted and fitted with secure, radius-corner doors. Solid oak raised doors, decorative mirrors, durable wall coverings, impressive insulation to add comfort in both cool and warm climates





*Feature loaded, value driven—
The road to travel*

and supremacy in all electric slide out mechanics are evidence of quality workmanship to last for years to come. Impressive and elegant— The Fifth Avenue boasts an upscale level of quality that is also affordable.



No matter where you look, Park Avenue and Fifth Avenue are the new standards of quality—

Feature by feature

NEW All new full fiberglass rear cap provides stronger structural integrity

NEW Interior cabinets feature solid oak radius stiles; no vinyl imitations!

NEW Sidewalls are made from a full 1-1/2" square welded aluminum frame

NEW Interior decorative wallboard is stylish and easy to maintain

NEW 1-1/2" polystyrene block foam provides a full R-7 insulation value

NEW Ceilings feature R-14 fiberglass insulation

NEW New full fiberglass front cap has recessed clearance lights

NEW Steel belly pan provides strong support and won't rot or weather

NEW Steel outriggers are a full 11" wide for stronger support

NEW Totally enclosed insulated underbelly (optional) and valves

NEW Rear axles are rated 5200 lbs.

NEW 16" radial tires are optional

NEW 2" vacuum bonded sidewalls

NEW Vinyl wood planking is optional on select models

NEW 6000 lb. electric front jacks provide more pushing capacity

NEW 10" steel I-beam frame is lighter and stronger than tube frames

Additional Quality Construction Features

- Roof rack & ladder
- 15,000 BTU ducted air conditioner (optional)
- One piece EPDM rubber roof w/ 12 year manufacturers warranty
- 3/8" Weyerhaeuser structure wood decking w/10 year warranty
- Ducted air conditioning through roof
- 5" truss roof rafters
- Optional exterior security light
- Smooth fiberglass filon exterior
- Steel perimeter wall supports
- Radiused cornered baggage doors
- Polystyrene block foam R-7 insulation in floors
- Galvanized steel under main floor
- Triple fold away steps
- Laminated steel floor
- 5/8" one piece Weyerhaeuser structure wood floor w/10 year warranty, screwed and bolted to frame• Radiused jalousie windows
- Butyl rubber tape used around all windows and compartment doors
- Laminated steel bath deck

R-VALUES

ALL WEATHER PACK

Roof - R-21
Wall - R-7
Floor - R-10
Underbelly -R-22

STANDARD UNIT

Roof - R-14
Wall - R-7
Floor - R-10

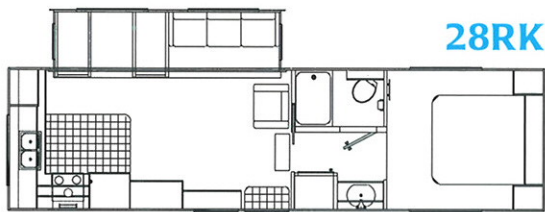

28RK

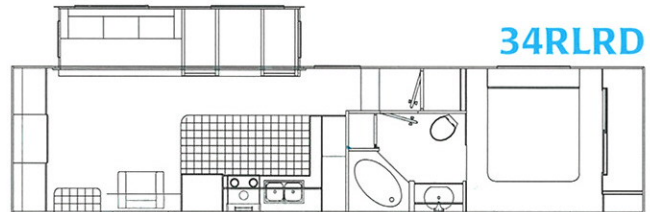

34RLRD

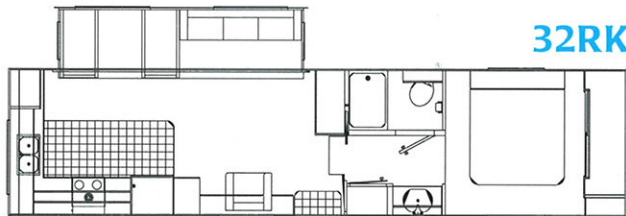

32RK

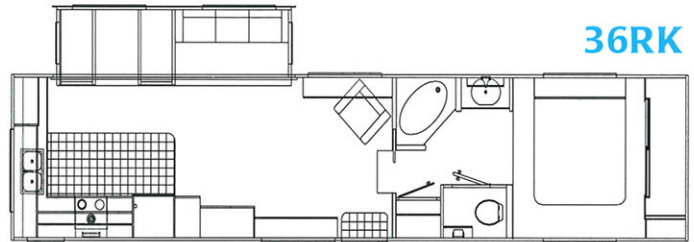

36RK

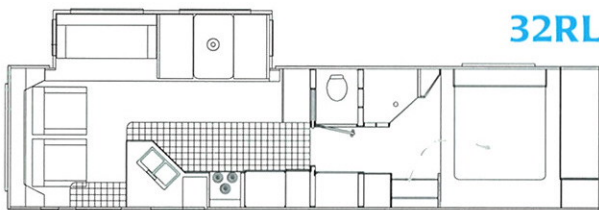

32RL

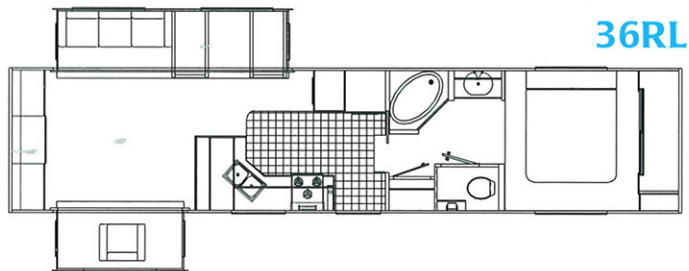

36RL

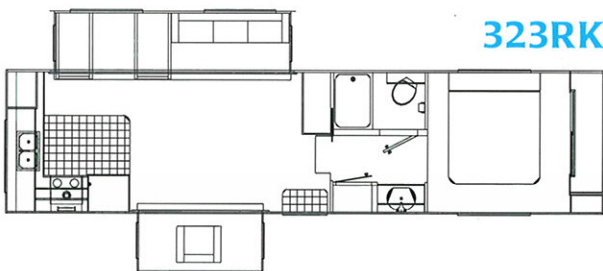

323RK

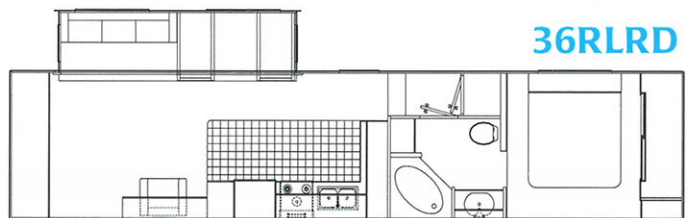

36RLRD

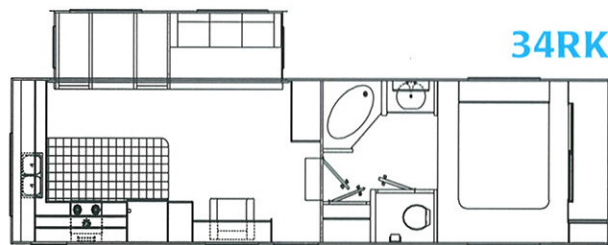

34RK

Options

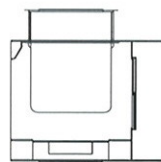

Option #1
All Units Except 28 RK

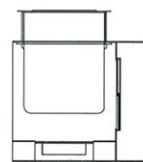

Option #2
28 RK Only

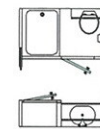

Option #3
(Tub)
28, 32, 323 RK



Option #4
(Garden Tub)
34, 36 RL RD

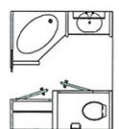

Option #5
(Garden Tub)
34, 36 RK, & 36 RL

Premium decors use in Fifth Avenue and Park Avenue interiors

All furniture is upholstered in stylish highgrade fabrics. Valences, trim and residential-type carpet add even more to the home like atmosphere of a Park Avenue or Fifth Avenue.



Bayside Blue



Galileo Green



Meadow Mauve

1998 Fifth Avenue & Park Avenue Standard Features

Exterior

- 30" radius entrance door
- Built-in twin 30# LP bottles w/auto changeover
- One Piece EPDM rubber roof
- Triple entry step(s)
- Flush door latch with dead bolt lock
- Locking baggage doors
- Radiused jalousie windows
- Outside storage compartment(s)
- Stone guard (Park Avenue only)
- Aluminum bumper cover (Park Avenue only)
- Sewer hose storage
- Patio Light
- Exterior light under goose neck
- Large front storage compartment
- Battery box compartment
- Grab handle at entrance door
- Squeegee seal around slide-out room
- Black water flush

Construction

- Smooth fiberglass exterior
- Aluminum framed fully laminated 2" sidewall
- Block foam insulation sidewall/floor
- 5" truss rafters with 3/8" decking full length
- Extra tough rubber roof (one piece)
- Track guided electric powered slide system
- Carpeted and lighted storage areas
- Laminated galvanized steel under floor
- One piece, 5/8" seamless Weyerhaeuser structure wood decking
- Solid oak radius stiles
- Steel laminated bath floor

Running Gear

- 10" I-beam frame
- 15" radial tires (forced option of 16" tires on 323RK)
- Electric brakes on all wheels
- Break away safety switch
- 5200 lb. Axles on all models

Electrical

- Ceiling light w/wall switch
- Battery box with positive ventilation
- Receptacles, 110 volt with ground fault interpreter
- 110 volt outlets in slide room
- 30 amp electrical service
- 55 amp convertor with charger
- Patio light

Bath

- Medicine cabinet with mirror door
- Power roof vent
- Shower/tub surround with glass door
- Thetford toilet
- Towel bar, tooth brush holder and toilet tissue holder

Appliances/Equipment

- Double door refrigerator
- Microwave
- 3-Burner range over high output burner
- 6 gal. Gas/electric water heater with DSI
- Double bowl stainless steel sink
- Sink cover
- 35,000 BTU furnace
- Demand water pump
- 13,500 BTU ducted A/C
- Water heater bypass
- Stereo/Cassette w/4 speakers
- Combination range exhaust, light, and monitor panel
- TV antenna with booster
- Cable tv hook up
- Second tv outlet with stand in bedroom
- Awning
- Roof Rack and ladder

Interior

- 60"x 74" queen bed (60"x 80" in bedroom slide out)
- Roof vents
- Fire extinguisher
- Smoke detector
- Oak edged countertops
- Solid oak cabinet doors
- Vinyl floor kitchen and entry
- Adjustable ceiling A/C ducts

- Interior oak grab handle at entrance door (N/A 36RL)
- Innerspring mattress
- Bedspread with shams
- Sofa Hide a Bed (Mastercraft)
- Booth dinette with storage door
- Decorative interior vinyl covered wallboard
- Mini-blinds
- Swivel Rocker
- Baltic birch solid wood drawer sides
- Bed lifters
- Designer valances
- Decorative galley rail

Fifth Avenue Standard Features

- Same standard features as the Park Avenue, plus the following
- All glass medicine cabinet (mirrored)
- Vinyl plank wood flooring in kitchen and entrance way
- RCA stereo with CD player and remote
- New fiberglass cap design (front and back)
- Fluorescent lighting throughout
- Rocker/Recliner/Glider chair
- Solid oak free standing dinette with 2 dinette chairs
- Day/Night shades
- Solid oak raised refrigerator fronts
- Skylight above shower/tub
- Shock absorbers
- Electric front jacks
- Spare tire carrier

Options Available

- Bedroom Slide out w/vanity
- Totally enclosed insulated

- underbelly
- Opt #3 Tub (28,32,323, RK's)
- Opt #4 Garden Tub (34, 36,RLRD's)
- Opt #5 Garden Tub (34, 36RK & 36RL)
- Add'l Swivel Rocker
- Rocker Recliner Glider
- Free standing dinette with 2 chairs
- 2 extra dinette chairs
- Extra large refer
- Washer Dryer prep, 10 gal. Gas/elec water htr, 50 amp service
- Day/night shades
- Solid oak raised panel refer front
- 10 gal gas/elec water heater
- Ceiling fan
- Phone jack
- Range cover
- Hardwood Slide out Facia
- Vinyl wood plank flooring (galley & entrance way only)
- Central vacuum with accessories
- Fantastic fan with reverse and rain sensor
- 40 Btu furnace
- 15 Btu A/C
- Poly air insulation (roof only)
- Scare light door side
- Scare light off door side
- Skylight above tub/shower
- Slide out gas bottle tray
- Rear stab jacks
- Shock absorbers
- 16" tires
- 16" spare tire w/carrier
- 15" spare tire w/carrier
- Slide out awning toppers
- Battery
- Electric front jacks
- Outside handicap grab handle

	28RK-BS	32RK-BS	32RL-BS	323RK-BS	34RK-BS	34RLRD-BS	36RK-BS	36RL-BS	36RLRD-BS
Length	30'	34'	N/A	34'	35'	35'	38'	38'	38'
Width	8'	8'	8'	8'	8'	8'	8'	8'	8'
Hitch dry weight	1960	2040	N/A	2000	1960	2140	1820	1940	2080
Axle Dry Weight	6860	7500	N/A	8180	7700	7700	8420	9160	8840
GVWR	12,360	12,440	N/A	12,400	12,360	12,540	17,420	17,540	17,680
UVW	8820	9540	N/A	10,180	9660	9840	10,240	11,100	10,920
NCC	3540	2900	N/A	2220	2700	2700	7180	6440	6760
Tandem Axles	2	2	2	2	2	2	3	3	3
Radial Tire Size	15"	15"	15"	16"	15"	15"	15"	15"	15"
Tire Load Range	D	D	D	E	D	D	D	D	D
Dual Waste Water	150	150	150	150	150	150	150	150	150
Fresh Water	55	55	60	55	55	60	55	60	60
Furnace BTU	35	35	35	35	35	35	35	35	35

Since we constantly strive to improve our product, all specifications are subject to change without prior notice. All weights include the bedroom slide option.



State Road 15 North • P.O. 338 • Bristol, IN • 46507
(219) 848-7411 • FAX (219) 848-1236

Your Local
Dealer