

2" THICK **ALUMACAT** SIDEWALLS  
ALUMINUM CAGE CONSTRUCTION

# eXtra Lite Travel Trailers



Designed with  
Green in Mind®

# Wildcat



## 26BHS

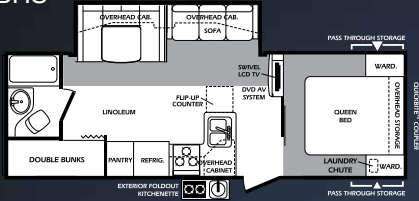

## 27RLS

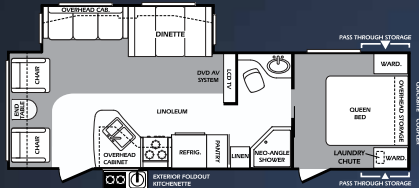

## 29BHS

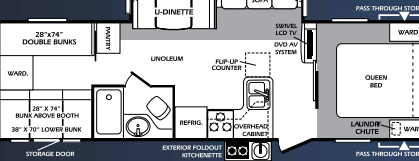

## 29FKS

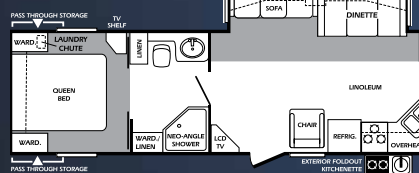

## 30BHS

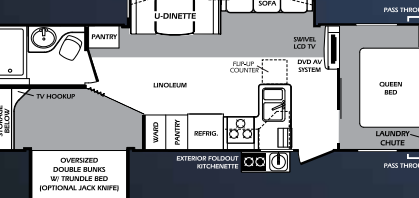

### STANDARD EQUIPMENT

- Executive chef kitchen (Mandatory)
- Real Wood Cabinet doors - not composite doors
- Oversized pots and pans drawers
- 105% larger pantry than competitors
- Deep two bowl sink with cutting board
- Residential full-extension drawer guides with ball bearings
- Residential porcelain toilet with foot pedal
- EZ lube hubs on axles on ALL MODELS
- 30,000 BTU furnace
- One-piece seamless rubber roof
- All windows in main slide out open
- Swivel rocker (27RLS-2, 29FKS-1)
- Cable/Satellite prep
- Quickbite™ Coupler (easy hook-up)
- 2" THICK **ALUMACAT** SIDEWALLS

### OPTIONAL EQUIPMENT

- Royal Package (Mandatory)
- Camp in Style Package (Mandatory)
- Camp Like a Pro Package (Mandatory)
- Climatech polar package (Mandatory)
- Electric awning (Mandatory)
- Carbon monoxide detector (Mandatory)
- Radial tires (Mandatory)
- Air mattress sofa
- Free standing dinette and 4 chairs
- State seal
- Canadian CSA
- RVIA seal

### ROYAL PACKAGE

#### (Mandatory Option Package)

- Residential oak refer front
- Outside kitchen cook center with sink
- Spray port attachment and outside shower attachment
- Spare tire
- Cutting board for outside kitchen

### CAMP IN STYLE PACKAGE

#### (Mandatory Option Package)

- Folding entry handle
- TV antenna with cable
- Outdoor all weather speakers
- 2" thick gel-coated filon fiberglass sidewalls
- Residential tiled shower surround
- 26" HD/LCD TV
- High-end 12 volt AM/FM/CD/DVD radio Surround sound speakers, MP3/auxiliary hook-up

### CAMP LIKE A PRO PACKAGE

#### (Mandatory Option Package)

- Pleated night shades
- Laundry chute
- Black framed tinted safety glass windows
- Microwave oven
- Aluminum framed sidewalls, floors, front and rear
- 13,500 BTU Air Conditioner

Model Number	Ship Weight	CCC	Hitch Weight	Length	Fresh Water	Black Water	Gray Water	LP Tanks	Tire Size
26BHS	TBD	TBD	TBD	28'10"	TBD	TBD	TBD	2 X 30	225/75 R15D
27RLS	TBD	TBD	TBD	30'5"	TBD	TBD	TBD	2 X 30	225/75 R15D
29BHS	6485	1405	920	32'5"	43	37	37	2 X 30	225/75 R15D
29FKS	TBD	TBD	TBD	32'5"	TBD	TBD	TBD	2 X 30	225/75 R15D
30BHS	TBD	TBD	TBD	32'11"	TBD	TBD	TBD	2 X 30	225/75 R15D

Pictured: [1] Wildcat eXtraLite's spacious master suite. [2] The master suite's built-in swivel flatscreen LCD/HD TV. [3] The bunk area of the 29BHS provides plenty of room to play and rest. [4] When it's time to travel, the bunk area of the 29BHS gives you abundant storage and easy access through the convenient stow and go door.



Forest River, Inc.  
55470 C.R. 1  
Elkhart, IN 46514  
(574) 389-4600

www.forestriverinc.com  
www.forestriveraccessories.com

