

ITASCA CARRIES YOU TO THE
COUNTRY. IT'S YOUR FIRST CLASS TICKET
TO AMERICA.

OUTSIDE, BEYOND TINTED GLASS
AND PANORAMIC WINDOWS, IS A WORLD OF
UNCEASING FASCINATION.

INSIDE, SAFE WITHIN ITASCA'S
LATTICE OF STRUCTURAL STEEL AND SPACE
AGE PLASTICS, YOU PRESS ON. LURED
BY THE PROMISE OF ENDLESS DISCOVERIES.
CONVEYED BY THE ESSENCE OF
AUTOMOTIVE TECHNOLOGY.

HIGH TECH?
OR HIGH ADVENTURE.



ITASCA



SUNFLYER

SUNFLYER 27

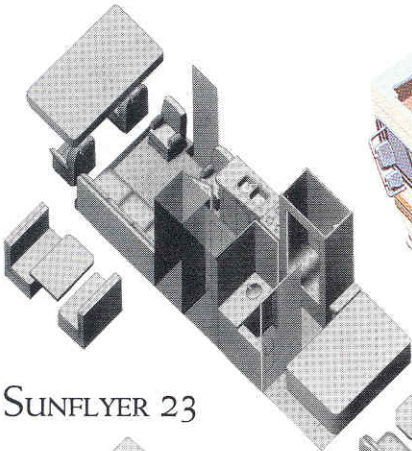

SUNFLYER 23

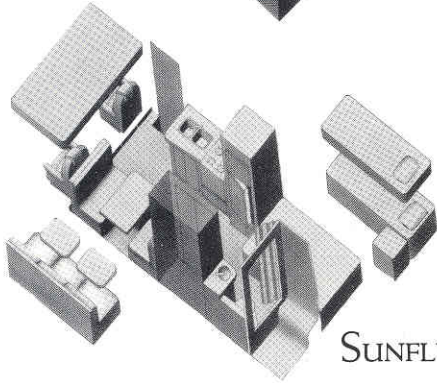
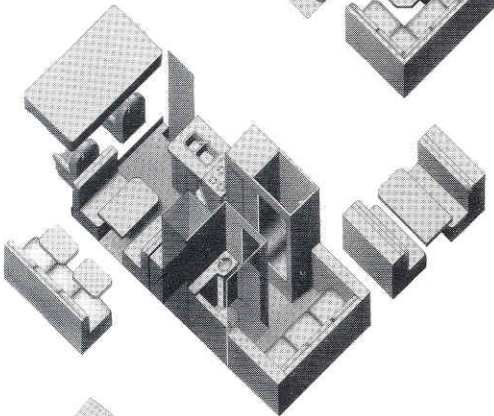

SUNFLYER 22

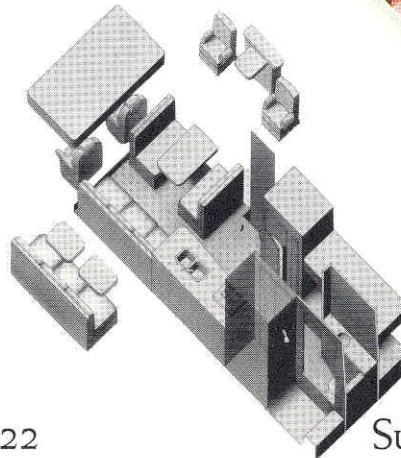

SUNFLYER 26RH

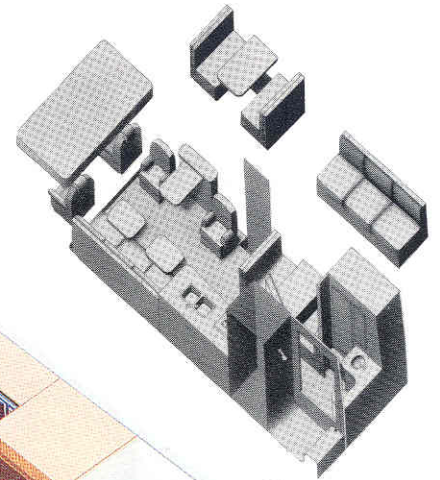

SUNFLYER 26RB

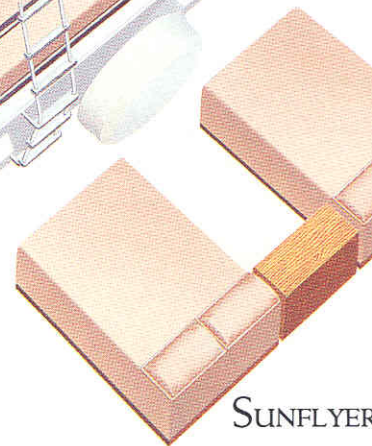

SUNFLYER 26

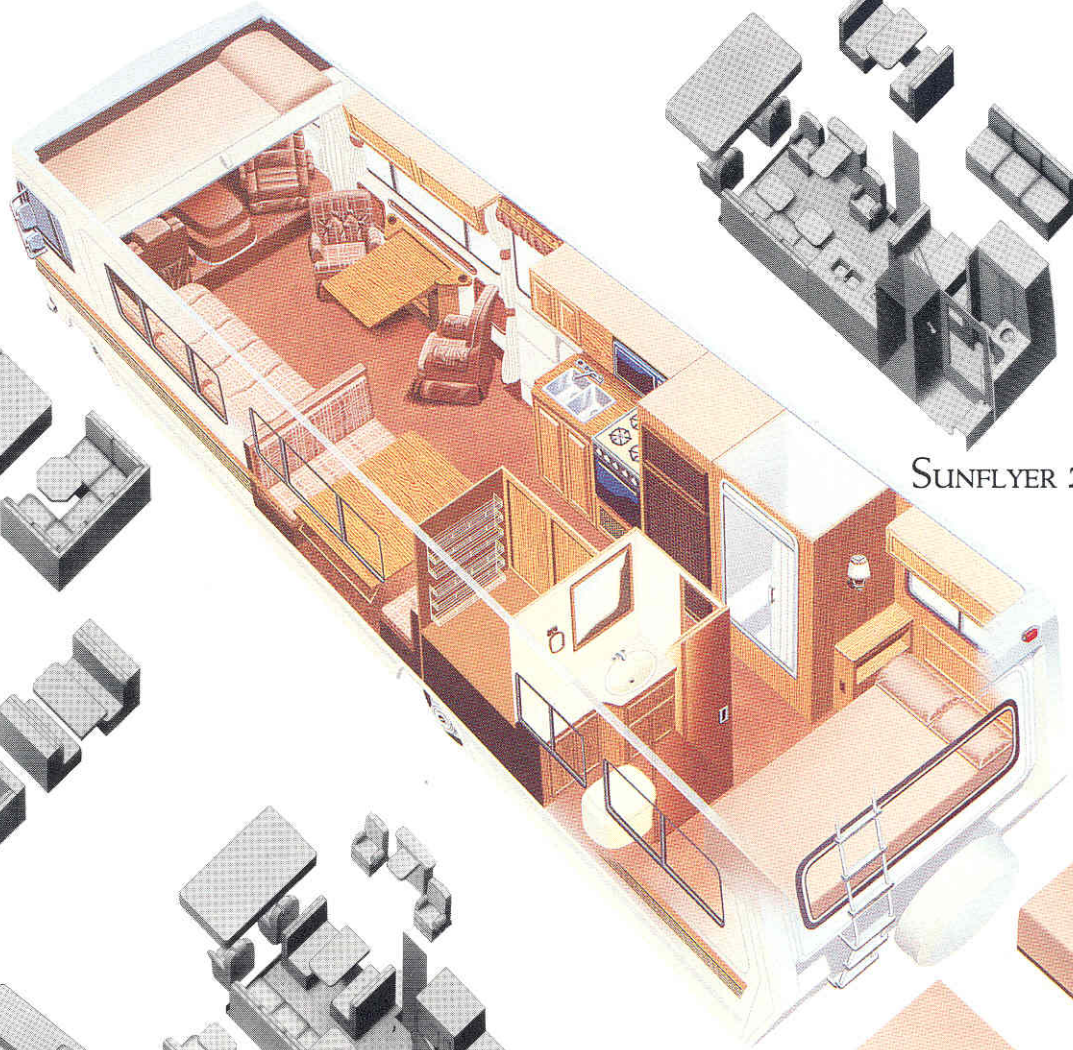

It's easy to see Sunflyer is the product of an intense commitment to quality and human engineered convenience. But what you don't see is the most remarkable feature of all.

Affordability.

It's not surprising that Sunflyer is consistently the choice of RVer's

who want to step up—but know there's no need to sacrifice unnecessary purchase dollars.

Sure, you can spend more. But it's hard to imagine a richer, more livable, more luxurious interior.

In fact, you'll find just about everything in Sunflyer. Except wasted space.

NOTES



SUNDANCER

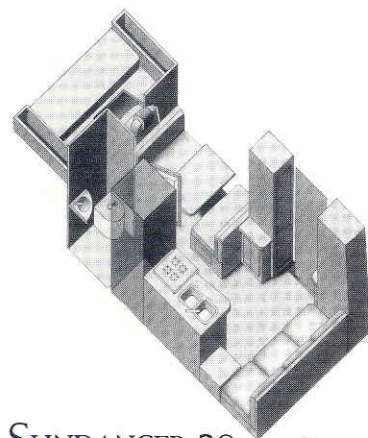
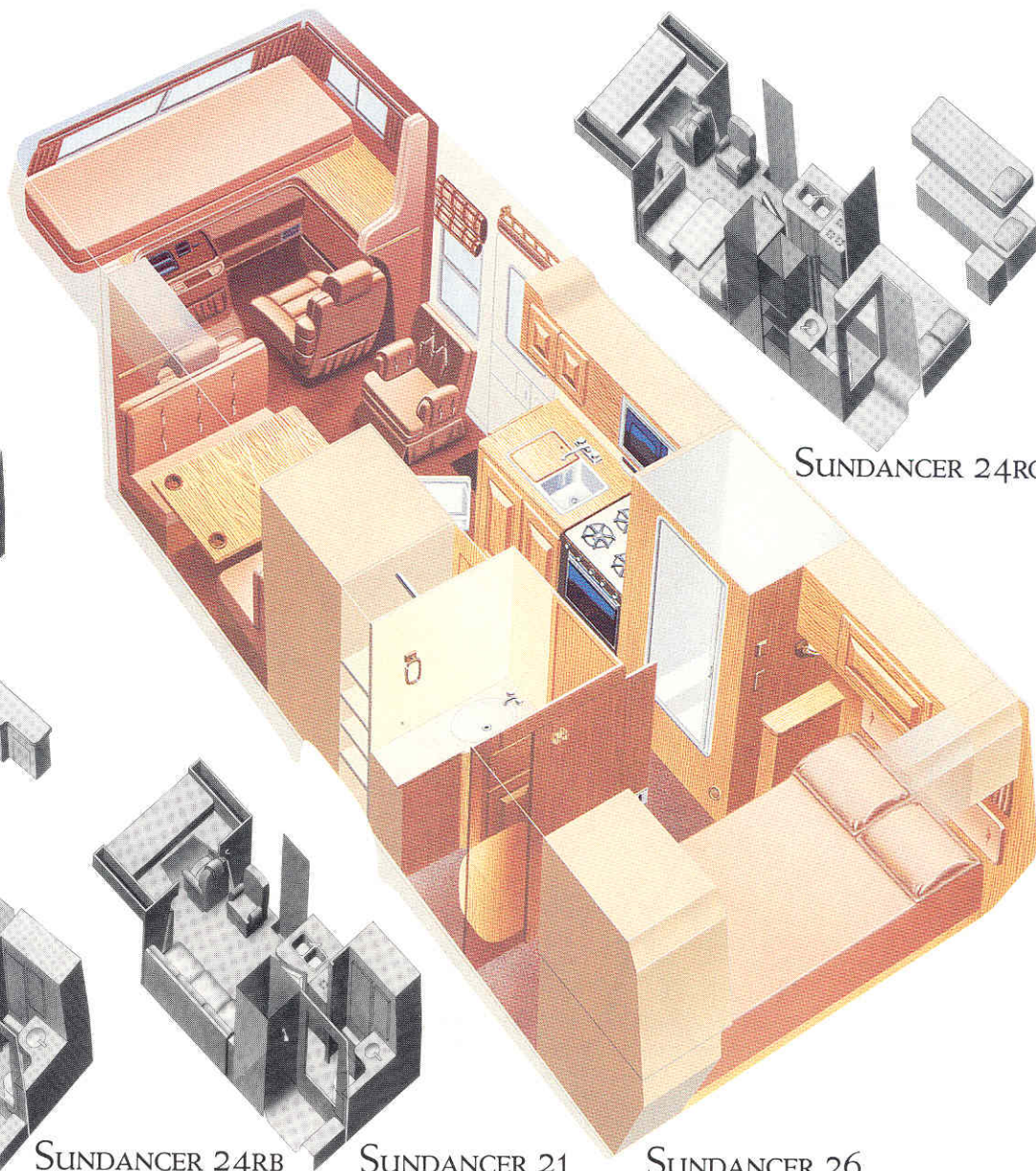

SUNDANCER 20

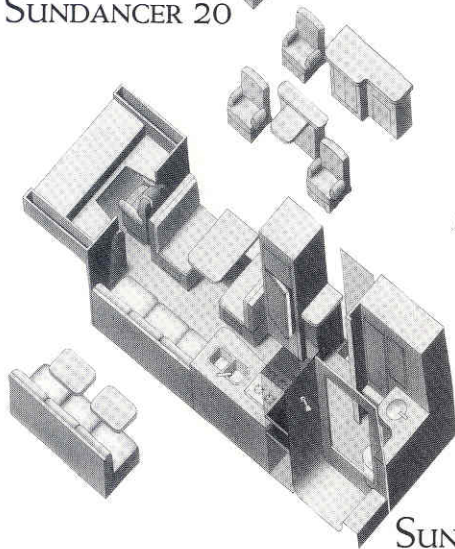

SUNDANCER 24RB

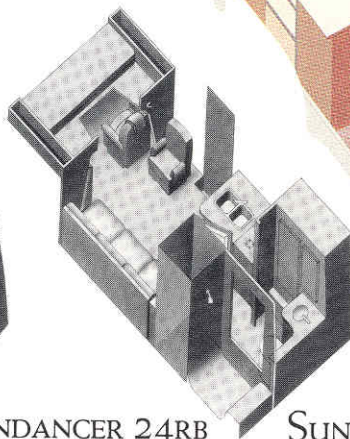

SUNDANCER 21

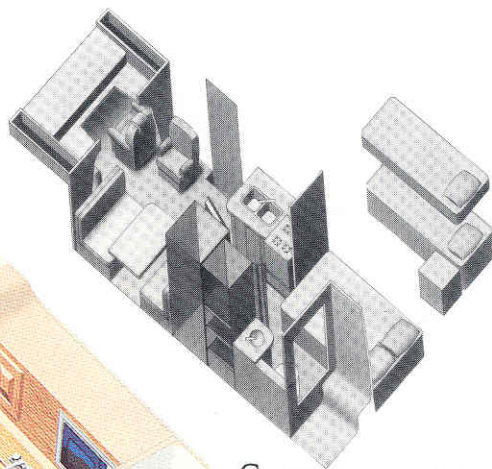

SUNDANCER 24RC

SUNDANCER 26

Sundancer is purely and simply a driving machine. A machine offering the comfort and convenience of a quality motor home — but not at the expense of performance and roadability.

Itasca has engineered a perfect marriage of coachwork and chassis. And the result is remarkable road handling characteristics under nearly

every conceivable condition.

Sundancer is strong and sure-footed in the outback. Smooth and stable on an interstate. And surprisingly nimble and responsive in city traffic.

Best of all, Sundancer is designed to be affordable. It's equipped to live effortlessly. And it's ready to take you anywhere. Whenever adventure calls.

NOTES



WINDCRUISER

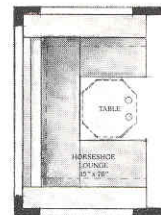
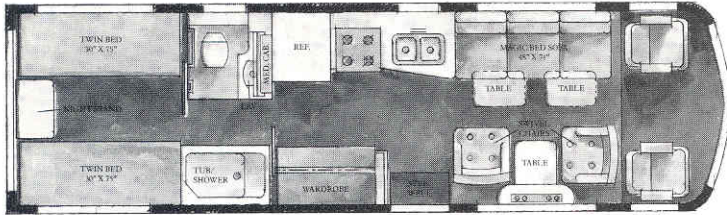

WINDCRUISER 28RU

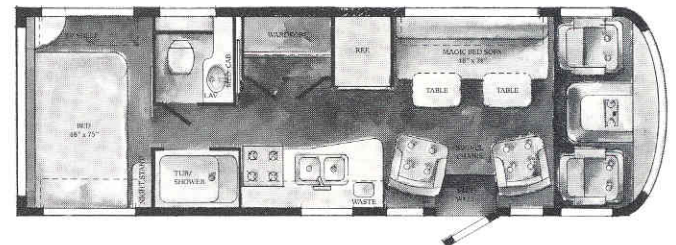
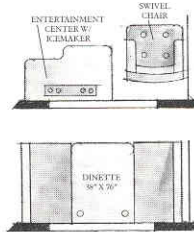
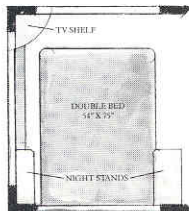
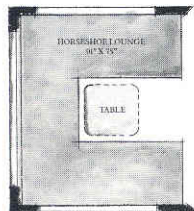
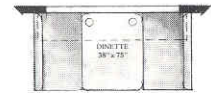

WINDCRUISER 31RT

WINDCRUISER 34RU

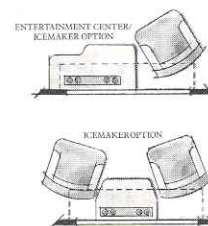
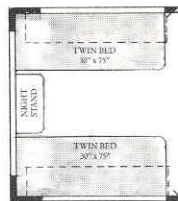
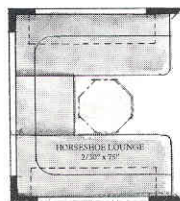
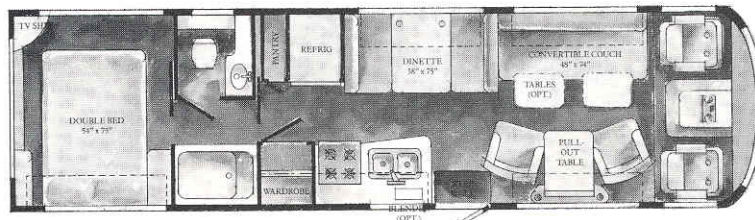

One look is all it takes. Windcruiser is state of the art. A product of Itasca's advanced automotive engineering. And the industry's most sophisticated design, manufacturing and testing capabilities.

From the unprecedented 40-degree rake of the windshield to

the optional driver and passenger doors—to the countless construction details that combine to deliver exceptional strength, durability and safety—Windcruiser is bold and new and distinctive.

Windcruiser is high tech. For high adventure.

NOTES