

WINNEBAGO®

Elan®





WINNEBAGO ELANDAN

THE BEST JUST GOT BETTER.

Every once in a while, a vehicle comes along that truly outclasses the competition in terms of style, luxury and value. In the motor home industry, that vehicle is the Winnebago Elandan®.

See for yourself. Elandan's sleek, aerodynamic design and dramatic new changes for '91 continue to set it apart. The streamlined profile, smoothly curved sidewalls and crowned roof are beautifully combined to give Elandan an unequaled style and grace. Inside, the elegance continues with rich hardwoods, softly coordinated fabrics and quality appointments that say this coach travels first class.

Elandan's most exciting new feature is a breakthrough storage compartment system that reinforces Elandan's position as the motor home design leader. Sturdy compartments with attached lids glide out from the lower exterior to make packing easier than ever before.

The nose has been restyled with a softly-sculpted new bumper, grille and headlight treatment. At the rear, a highly-functional new fiberglass cap houses electrical and fresh water centers, plus 10 cubic feet of additional storage.

Still the best looking motor home on the road. Elandan has more of the smooth, aerodynamic styling of an automobile than any other RV. Here you see the incredible new roll-out compartments in use — the hottest news in motor home storage for 1991. Stylish stainless steel wheel liners, optional on many motor homes, are standard on Elandan.



High-backed, leather-like driver and passenger seats add pure driving comfort to long hours on the road. The deluxe dash features automotive air conditioning, Sony AM/FM cassette stereo, built-in cassette storage drawers and rear-vision monitor. The 13" remote control color TV is located overhead for comfortable viewing.



Efficient fluorescent lighting lines Elandan's sound-absorbing, soft vinyl ceiling. Rich oak-doored cabinetry and woodwork are combined with the soft colors and textures of Winnebago's own specially-crafted furniture. And every Elandan is conveniently equipped with three phone jacks. Wood parquet galley flooring is an exquisite new standard feature.





Inside are some equally wonderful new design enhancements that help create an even more comfortable living environment.

An electrically telescoping passenger seat lowers to serve as a new front lounge chair. This frees space to allow the addition of a seven-foot long "gourmet" galley in the 37RQ.

For the 33RQ, the additional space means that all three of the most popular seating arrangements – a dinette, couch and lounge chairs with pull-up table are included. And the 37RQ bath has been upgraded with a new, glass-enclosed shower.

Elandan's unique automotive-style driver and passenger doors feature new power windows and locks. Also new this year is a handy remote control keyless entry system, popular on so many of today's luxury automobiles. It activates the door locks and porch light from inside or out.

Every picture tells a story, so read on and discover how there's more to Elandan's beauty than meets the eye. Why spend up to twice as much when you can have everything you want in an Elandan? One look, one test drive, one traveling experience in this luxurious motor home and you'll soon be repeating that well-worn phrase, "life just doesn't get any better than this."

The 37RQ features a new 7' gourmet galley with high-style Avonite® counter top. Glass panel door inserts add beauty to cupboards framing the galley window. A microwave/convection oven with turntable is also standard. And a pull-out pantry on the 37RQ, slide-out cutting board, trash container, plus dinette storage drawers provide more of the conveniences of home.



A mirrored medicine cabinet and make-up lights add bathroom beauty and convenience. You'll appreciate the large rectangular sink and the mirror-doored wardrobe closet conveniently located nearby.



Choose the queen-sized bed and you get center-island overhead storage, mirrored shirt wardrobes and matching night stands with reading lights. Add the relaxing sound of a deluxe AM/FM auto-reverse cassette stereo with alarm clock, headphone jack and digital display. Day/night pleated blinds and valance coordinate with the beautiful bedspread and pillow shams. A second generator switch is also conveniently located here.



The spacious 37RQ bath features a large, glass-enclosed shower with skylight. Folding divider doors provide bathroom privacy or, by opening the rear door, a spacious bath/bedroom suite. The porcelain marine toilet includes a spray cleaning attachment. A second water pump switch is an added step saver.



A handsome, overhead corner TV cabinet is new in the bedroom. It features a 9" remote control color TV with antenna, VCR and cable connections.





Elandan's handsome new front end features an aerodynamic grille and headlight combination. Pantographic windshield wipers provide greater efficiency in snow or rain. Like all Winnebago models, the safety glass windshield and the wipers are firmly attached to the steel cab structure, not to fiberglass like some competitors. A handy telescoping windshield squeegee is stored under the hood.

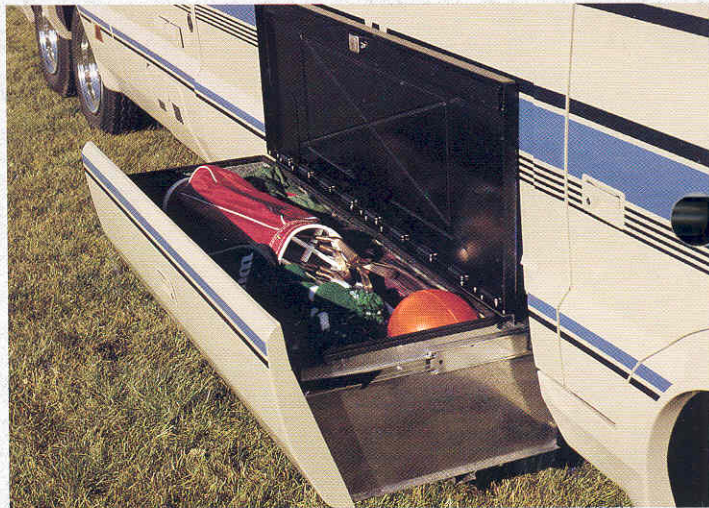

The talk of the industry for '91 is Elandan's innovative roll-out storage compartments. Each lockable section features a sturdy vacuum-formed ABS lid for added protection from the elements. An extra large compartment, located next to the side entry door, is deep enough to carry two sets of golf clubs and more. And each is fully lined with carpeting to absorb sound and protect your precious cargo in transit.

SPECIFICATIONS:

	33RQ	37RQ
Length	33'10"	37'5"
Exterior Height w/Roof Air		
Chevrolet	10'2"	10'2"
Ford	10'4"	10'4"
Exterior Width	8'	8'
Interior Height	6'5"	6'5"
Interior Width	7'7"	7'7"
Fuel Capacity (Gals. Chev./Ford)	78/75	78/75
Fresh Water Capacity		
(Gals. w/Heater)	76	76
Holding Tank Capacity (Gals.)	75	75
LP Capacity (Lbs.)	100	100
Electronic Ignition Furnace (BTUs)	34,000	34,000
GVWR (Lbs. Chev./Ford)	16,000/17,000	17,000/18,000
Wheelbase	200"	208" + 40" Tag

STANDARD EQUIPMENT:*

AUTOMOTIVE FEATURES:*

Chevrolet Chassis: 7.4L 454 V-8 Fuel-Injected
 Gasoline Engine
 Automatic Transmission w/Cooler
 Coil Spring Front Suspension w/ Aux. Air Springs
 Leaf Spring Rear Suspension (33RQ)
 Self-Proportioning, Air Suspension Drive Axle
 w/Torsional Rubber Tag Axle Rear Suspension (37RQ)
 Radial Tires & Spare
 630-CCA Battery
 105-Amp. Alternator
 Front Stabilizer Shocks (37RQ)
 Automatically Applied Parking Brake
 Multi-Function Signal Lever w/Intermittent Wipers/
 Washer & High/Low Beam Headlight Control)
 Stainless Steel Wheel Liners
 Emergency Start Solenoid (Dual Battery Switch)
 Auxiliary Battery Disconnect Switch
 Automotive Air Conditioning
 Power Assist Steering w/Tilt Wheel
 Cruise Control
 Telescoping Windshield Squeegee Stored Under Hood
 Map Light
 Electronic Tune AM/FM/Cassette Stereo
 w/Four Speakers
 Radio Power Switch for Main or Auxiliary Battery Use
 Deluxe Flexsteel® Bucket Seats w/Soft Touch
 Leather-Like Vinyl (Reclining, Swivel/Slide,
 Armrests, 3-Point Retracting Seat Belts, Passenger

Seat Has Telescoping Pedestal)
 Driver and Passenger Doors w/Power Windows
 & Switch to Activate Courtesy Lights
 Storage Cabinet Above Cockpit
 Power Door Locks w/Remote Control
 Oak Beverage Tray w/Storage Compartment,
 Ashtray & Cupholder
 Sunvisors
 Remote Hood Release
 Front Wraparound Curtain
 Custom Steering Wheel (Chevrolet 37RQ)
 Auxiliary 2-Speed Defroster Fans w/Switch
 Molded Cab Door Panels
 Vacuum Gauge
 ICC Blink Switch
 Courtesy Light
 Extensive Warranty (Complete Details of Warranty
 Terms and Conditions are Available at Any
 Winnebago Dealer).

APPLIANCE/SAFETY FEATURES:*

13" Color TV w/Remote & Cabinet Above Cockpit
 Forward-mounted 110V. TV/VCR Inverter
 9" Color TV w/Remote & Cabinet In Bedroom
 800 Watt Microwave/Convection Oven w/Turntable
 Powered Range Hood w/2-Speed Fan & Light
 Monitor Panel - Features Water, Holding & LP Tank
 Levels, Water Pump Switch, Water Heater Ignition
 Switch, Coach Battery Condition, Generator
 Start/Stop Switch & Generator Hourmeter Gauge
 Large, Flush-Mounted Double-Door
 Refrigerator/Freezer

Direct Drive Demand Water Pump w/Galley, Bathroom
 & Rear Cap Switches
 Double Stainless Steel Sink w/Butcher Block Cover
 & Single-Lever Faucet
 6-Gal. Electronic Ignition Water Heater
 Motoraid Water Heater & Auxiliary Rear Heater
 40-Amp. Converter/Battery Charger
 Water Purification System
 LP Leak Tester
 Smoke Detector
 Ground Fault Interrupter
 10-B.C. Fire Extinguisher
 Rear Escape Window

INTERIOR FEATURES:*

Floor Mats (Driver, Passenger, Entry)
 Stain Resistant Carpeting w/Foam Pad
 Fluorescent Ceiling Lighting
 Padded Vinyl Ceiling
 Vents (Coach, Galley, Bedroom)
 Aisle Courtesy Light by Entrance Door
 Decorator Wall Clock
 Innerspring Mattress(es)
 Bedspread(s) & Pillow Shams
 Bedroom Decorator Lamps
 Bedroom Day/Nighter Pleated Blinds w/Cloud Valance
 2nd Generator Switch in Bedroom for Convenience
 Lighted Wardrobe w/Beveled-Edge Mirror on Door,
 Carpeted Bottom Shelf, Wooden Drawers
 & Cedar Panel
 Decorative Lamp Above Dinette (NA Canada)
 Oak Mini Blind in Galley
 Radius-Cornered Cabinets w/Solid Oak Overhead
 Doors & Spring-Loaded Props
 Cupboards w/Decorative Glass Panel Door Inserts
 Framing Galley Window
 Parquet Wood Galley Floorcovering
 Slide-Out Cutting Board (37RQ)
 Pull-Out Pantry (37RQ)
 Avonite® Countertop w/Galley Rail
 Knife Rack Built into Countertop
 Trash Bag Holder on Slide-Out Shelf
 Lounge Decorator Lamp
 Reading Lights in Lounge & Bedroom
 Swinging Bath Door (33RQ)
 Shower/Tub w/Flexible Head & Glass Door
 Shower Skylight
 Lavatory w/Brass-Tone Single Lever Faucet
 Porcelain Marine Toilet w/Spray Cleaning Attachment
 Linen Storage Shelves (33RQ)



Elandan features automotive-type driver and passenger doors with solid steel inner frames, integrated step well and power windows and locks. Remote-control, heated mirrors with convex elements are standard.



The attractive new fiberglass rear cap features an electrical center, with 30' power cord, telephone and TV hook-ups, located in the left compartment. A fresh water center with water connections, a handy shower head and a third water pump switch is on the right. Ten cubic feet of additional storage is available in the center compartment. The luggage rack and ladder are standard.



Wood-Framed Mirrored Medicine Cabinet
Make-Up Lights
Brass/Chrome-Tone Accessories Includes:
Soap Dish
Towel Ring
Towel Bar
Recessed Tissue Holder
Toothbrush/Tumbler Holder
Powered Lavatory Vent

EXTERIOR FEATURES:*

2 Deep Cycle RV Batteries in Stepwell Battery Box
30' Power Cord in Lighted Storage Compartment
Dump Valve Light
110-Volt Curbside Outlet
TV Antenna w/Two Jacks & Cable Ready
Roll-Out Carpeted Storage Compartments
20' Sewer Hose & Storage Compartment
Lockable Water and Fuel Fill Doors
Shower w/Faucet In Rear Cap
Flexible ABS Bumpers Over Steel Substructure
Secondary Dead-Bolt Lock in Entrance Door
Screen Door
Electric Entrance Step(Double)
Trailer Towing Package w/Class II Hitch & Trailer
Wiring Pigtail
Generator Prep Kit Includes:
12-Volt Wiring
Gasoline Line

Steel Compartment Floor
Roof Air Pre-Wiring
Tire Tools(Wrench, Lever Bar, Tool Bag)
Electronically Controlled & Heated Side Rear-View Mirrors w/Stylized Fairings & Convex Mirror Element
Tinted Windows
Luggage Rack & Ladder
Fog Lamps
Mud Flaps - Front and Rear

OPTIONAL EQUIPMENT:*

Ford Chassis: 7.5L 460 V-8 Fuel-Injected
Gasoline Engine
Automatic Transmission w/Cooler
Mono-Beam Axle w/Leaf Spring Front Suspension
Leaf Spring Rear Suspension (33RQ)
Self-Proportioning, Air Suspension Drive Axle w/Torsional Rubber Tag Axle Rear Suspension (37RQ)
Radial Tires & Spare
650-CCA Battery
100-Amp. Alternator
Foot Operated Park Brake
Intermittent Wipers
Rear Air Bags & Front Stabilizer Shocks (33RQ Chev.)
4,000 or 6,500-Watt Generator
Coleman Super Mac® Roof Air Conditioner(s) w/Thermostat Control
Water Heater Winterization By-Pass Valve
Range w/Large Oven

Central Vacuum Cleaner w/20' Hose, Tools & Turbine Power Brush
Large Double-Door Refrigerator/Freezer w/Ice Maker
AM/FM Auto-Reverse Cassette Stereo w/2 Speakers, Alarm Clock, Headphone Jack & Digital Display in Bedroom
VCR & Switching System
Rearview Video Monitor System w/Audio
Power Galley Ventilator Fan
6-Way Power Driver's Seat
Custom Steering Wheel (33RQ Chev.)
Roof-Mounted, Remote Control Spotlight
Jet Air Suspension w/Park & Level Feature (33RQ)
Hydraulic Leveling System w/4 Legs
Chrome Air Horns (Compressor w/50' Hose, Air Chuck, Gauge & Fittings)
Undercoating
Color Options: Swiss Mocha or Sapphire

*Not all standard features or options are available on all models. See your dealer for availability of specific options.

Winnebago's continuing program of product improvement makes specifications, equipment, model availability and prices subject to change without notice. Some items shown may be extra-cost options.

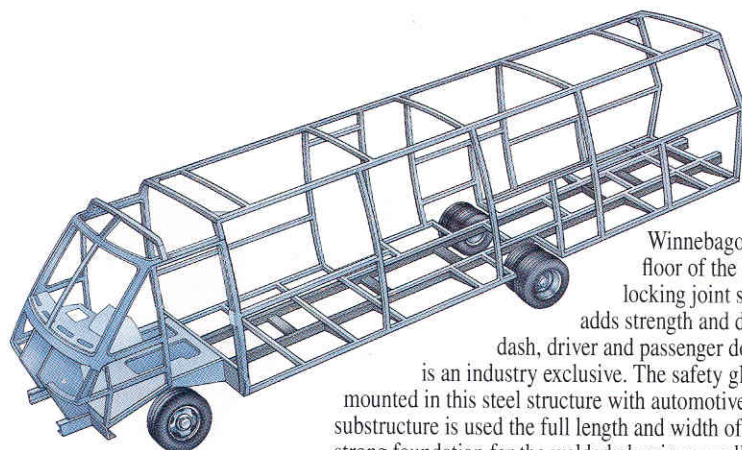

Winnebago joins the roof, sidewalls and floor of the Elandan with an exclusive locking joint system (shown at right) that adds strength and durability. Elandan's cab, dash, driver and passenger door welded steel substructure is an industry exclusive. The safety glass windshield is firmly mounted in this steel structure with automotive grade adhesive. Steel substructure is used the full length and width of the coach to provide a strong foundation for the welded aluminum wall and roof structure.

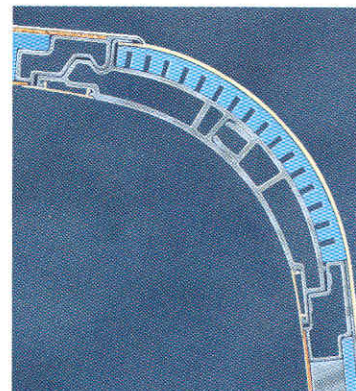

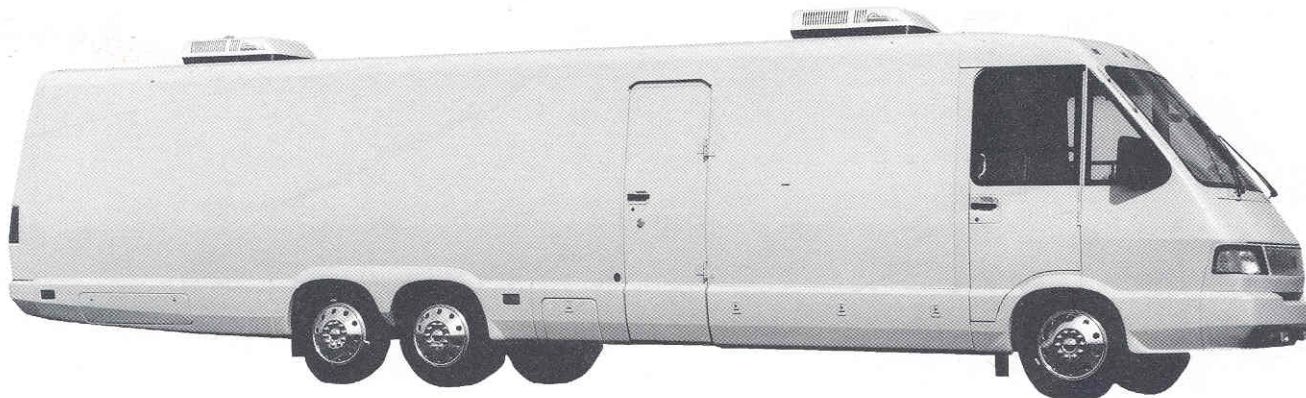

A MOTOR HOME CAN BE ANYTHING YOU WANT IT TO BE.

Can you do a better job by taking your product or service to people instead of waiting for them to come to you? In

business, health services, education and government, Winnebago Industries Special Vehicles are serving as classrooms, showrooms, labs, mobile police stations and many other functions.

Elandan has a workhorse Special

Vehicle cousin that provides all the cockpit comforts, load carrying capacity and systems (heating, air conditioning, etc.) of a motor home while leaving the interior open to your custom designs. Ask your dealer for more information.

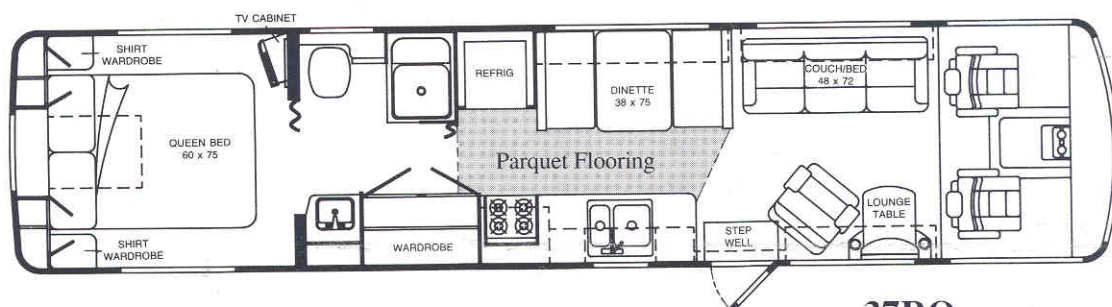
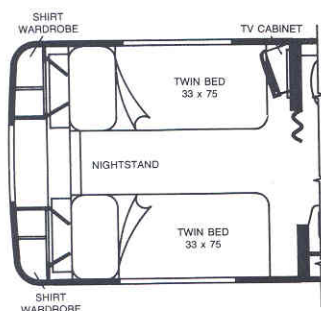

37RQ

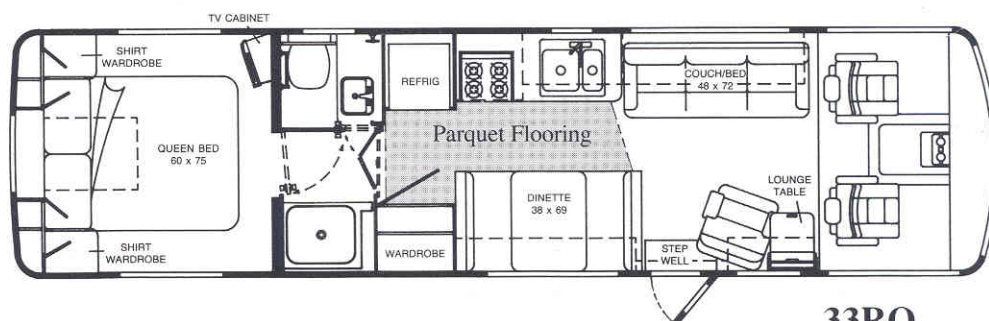
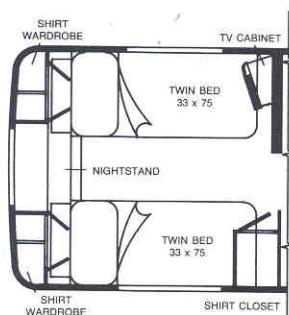

33RQ

Dimensions shown are for sleeping space only and dotted lines denote overhead storage area.



Every Winnebago owner is invited to join the Winnebago-Itasca Travelers (W.I.T.) Club. Members enjoy rallies and caravans, receive special discounts and services, make new friends and renew old acquaintances, and, of course have the time of their lives. For more information, call W.I.T. at (515) 582-6874.

If you are in the Forest City area, be sure to take the free Winnebago Industries factory tour. For more information call 1-515-582-6936.

For Winnebago Sales and Service, contact:

THE UNBEATABLE ELANDAN
WINNEBAGO